

Portable EV Charger

User Manual



User Guide

EVSE Portable Charger for Electric Vehicles

Thank you for choosing the portable EV Charger, in order to help you use this product properly, please read this user manual carefully before using the product.



Caution

Do not expose the control box to rain.

Do not immerse the charger in water.

Do not damage the products maliciously.

Avoid dropping the communications box or pressing heavy objects on its surface.

Keep the charger away from high temperature.

Do not place the charger in the car or in a confined space when charging.

The operating temperature of this equipment cannot exceed -30°C to +50°C.



Warning

Use with RCD circuit breaker only.

Do not use this product if the EV charging cable is damaged.

For electric vehicle charging only.

This product must be grounded properly when used.

Do not put fingers into the charging plug.

This product does not contain user-serviceable parts, please do not try to repair or maintain the product on your own.

If the charger cannot be charged normally accordingly to the user manual, please contact the dealer for repair or replacement.

Product Description

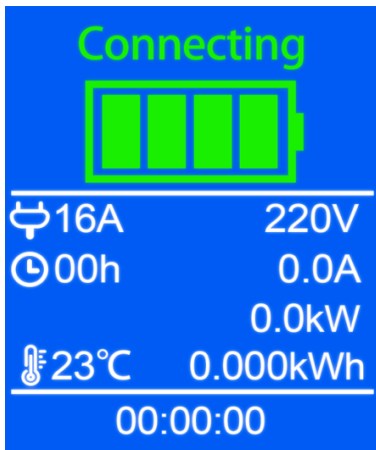
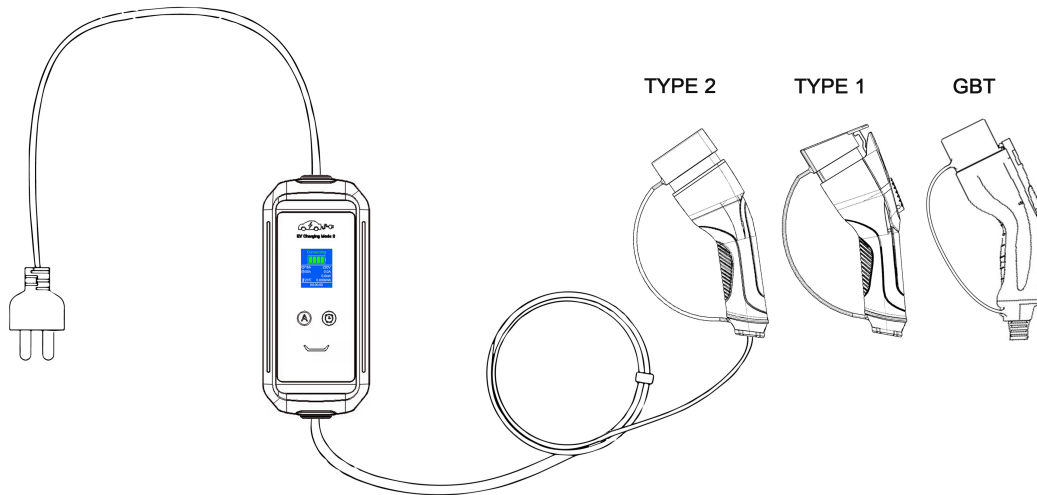

Communications box (LED Screen)	
Status LED Meaning:	
23°C	:Temperature
16A	:Rated current
220V	:Voltage
0.000kwh	:Electricity consumption
00:00:00	:Predict /actual Charging time
0.00kw	:Power
0.0A	:Constant current
00h	:delay charging time

LED State	Blue	Green	Red
Ready	On	N	N
EV Connected	Flash	N	N
Charging	N	Pulsing	N
Charge Complete	N	On	N
Fault	N	N	Flash

Product Description

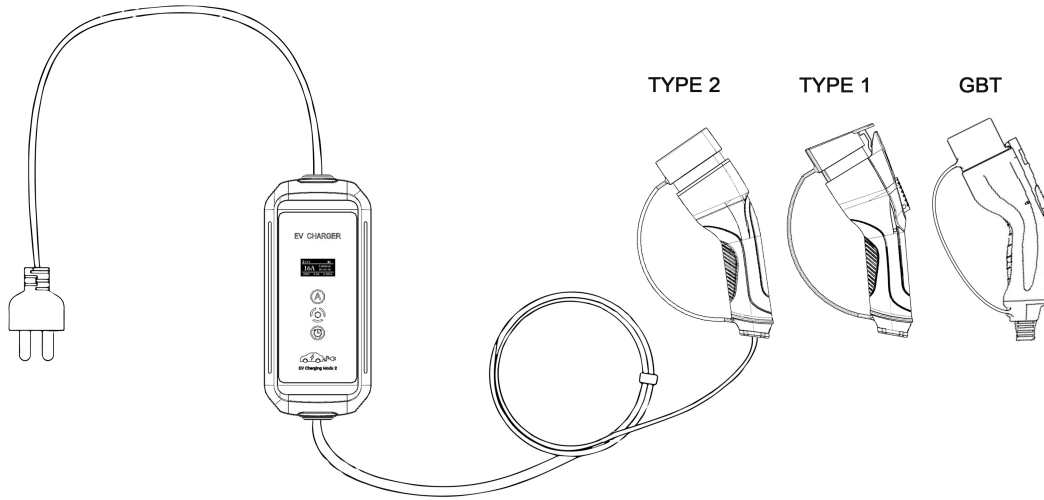

Communications box (LED Screen)	
Status LED Meaning:	
24°C	:Temperature
16A	:Rated current
220V	:Voltage
0.000kwh	:Electricity consumption
00:00:00	:Predict /actual Charging time
0.00kw	:Power
0.0A	:Constant current

LED State	Fault Yellow	State Green	Charge Red
Ready	Off	On	Off
EV Connected	Off	Fast Flash	Off
CP Error	Slow Flash	Off	Off
Charging	Off	Pulsing	On
Charge Complete	Off	On	Off
Fault	Flash	Off	Off

Product Description

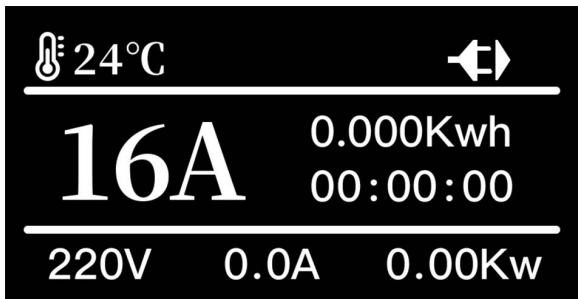
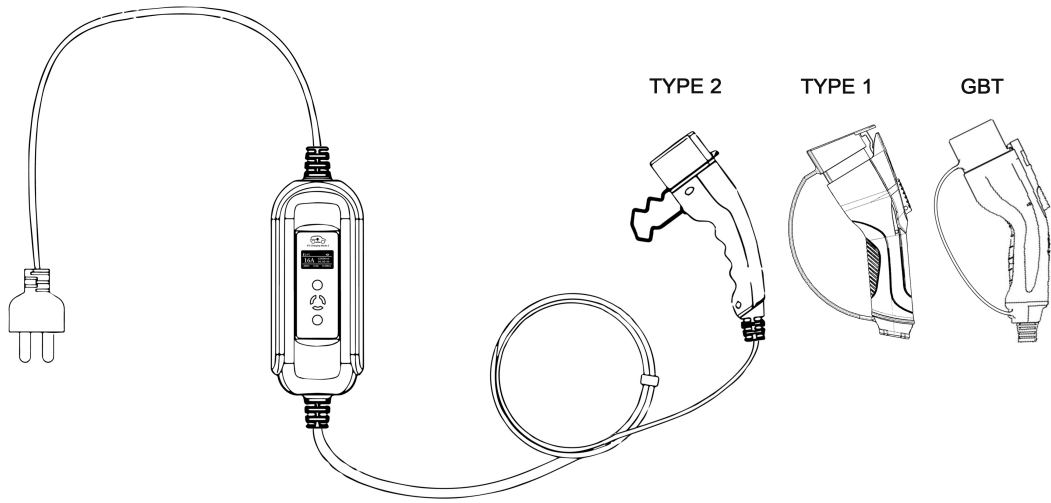

Communications box (LED Screen) Status LED Meaning:	
23°C	:Temperature
16A	:Rated current
220V	:Voltage
0.000kwh	:Electricity consumption
00:00:00	:Predict /actual Charging time
0.00kw	:Power
0.0A	:Constant current

LED State	Fault Yellow	State Green	Charge Red
Ready	Off	On	Off
EV Connected	Off	Slow Flash	Off
CP Error	Off	Fast Flash	Off
Charging	Off	Pulsing	On
Charge Complete	Off	Flash	Off
Fault	Flash	Off	Off

Product Specification

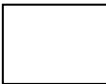
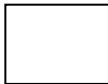
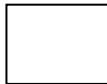
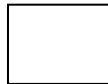
EV Portable Charger				
MARK ✓ for Correct Type				
Plug Type:	Type 2/ Type 1/ GBT	Type 2/ Type 1/ GBT	Type 2/ GBT	Type 2/ GBT
Rate Voltage:	220V~250V AC	220V~250V AC	220V~250V 380V~450V AC	220V~250V 380V~450V AC
Rated Current:	8-10-13-16A (MAX) Mono phase	16-26-32A(MAX) Mono phase	8-10-13-16A (MAX) Three phase	16-26-32A(MAX) Three phase
Power Rate:	3.6 KW	7.2 KW	11 KW	22 KW
Cable Specification:	3*2.5mm ² +1*0.75mm ²	3*6mm ² +1*0.75mm ²	5*2.5mm ² +1*0.75mm ²	5*6mm ² +1*0.75mm ²

Operating Temperature:	-30°C to +50°C
Storage Temperature:	-40°C to +80°C
Enclosure:	In-Cable box: IP66 Charging Connector: IP54

Precautions

Make sure that the charger is free from any abnormal conditions, such as laceration, rust, rupture or breakage of charging ports, cables, control boxes, wires, and plug surfaces.

Please do not use this charger if the socket is damaged, rusted, cracked or loosely connected. Do not start using if the plug is dirty or wet!!! Wipe with a clean and dry cloth to make sure it is dry and free of dirt.

Make sure that the plug at the power supply is consistent with the power supply socket before charging.

Adjust Current Before Connect The Car, Timer Function After Connect The Car.

How to start charging

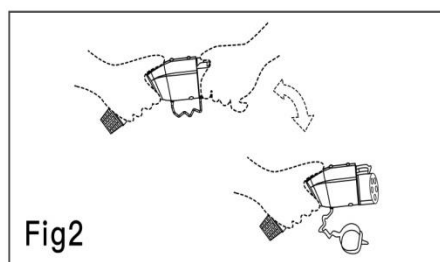
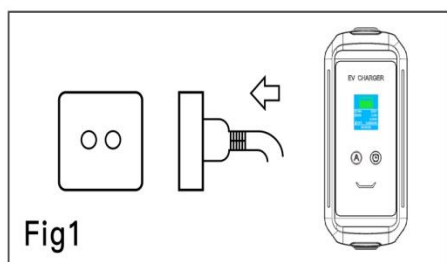

- 1, Take out the charging cable and insert the plug into the power supply socket.
- 2, push the blue button on the controller to adjust the current.
- 3, please remove the protective cap and fully insert the charging connector into the charging

port. Make sure the connector is fully inserted into the socket.

4, if the charging device operates automatically, the red light will always be on, and the green light will be flashing.

How to stop charging

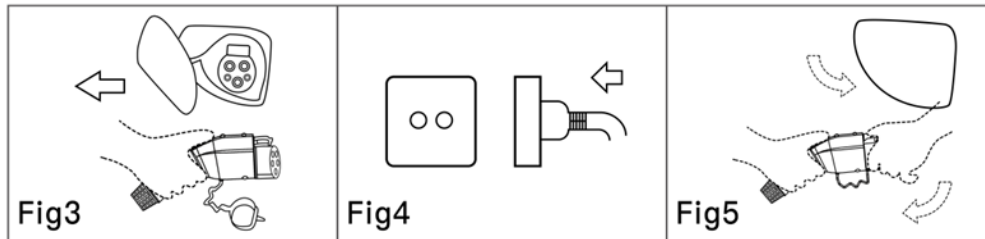

1, disconnect the charging connector from the vehicle inlet socket.

2, disconnect the plug from the outlet socket.

3, close the protective shell of charging port at the car end, and then cover the protective cap of the charging connector. put the charger into the bag.

Current (AMP) Switching of the Controller

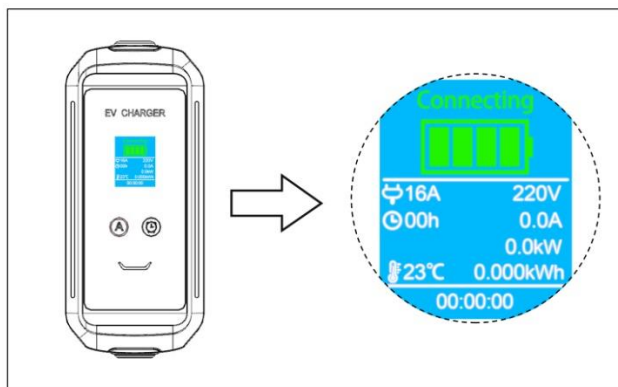

In order to switch charging current, make sure the power plug is firmly inserted into the socket and the end of the EV vehicle is disconnected, and then press the blue switch button/ (A) .

The charging current will be successfully switched. Presses the green button/ (clock) can set predict charging time, which supports charging after 1-15 hours.

How to use the APP

If the device with APP function, please check the following operation to connect APP through WIFI step by step: Search for “Tuya Smart “APP in Google play or Apple Store

Make sure charger and mobile phone in the same Wifi network (5G Wifi is not supported) and mobile phone close to the Bluetooth connect area on the charger.

When the device is powered on, the Tuya Smart APP is opened, and the network status of the charging device is displayed as follows, it indicates that the network configuration operation is required. (1)

After the charging device is successfully connected to the network, the network status of the charging device is displayed as follows (2): The network has been configured successfully, but the Wifi is not connected to the Internet. The network status of the charging device is displayed as follows (3)

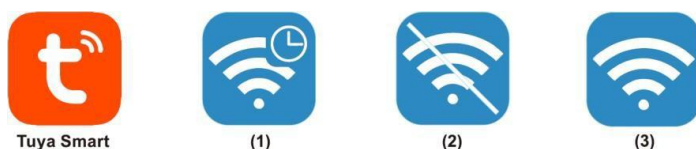

Open the Tuya Smart App, touch the plus sign in the upper right corner, and automatically discover the device, open the permissions, and start searching, as follows. Enter the device's working Wifi and password, wait for the charging device to be successfully added to the network, and enter the App charging display interface.

Note: negligently press red button can clear internet record on APP control through wifi, or change home WIFI password, the network must to be reconfigured as first time.

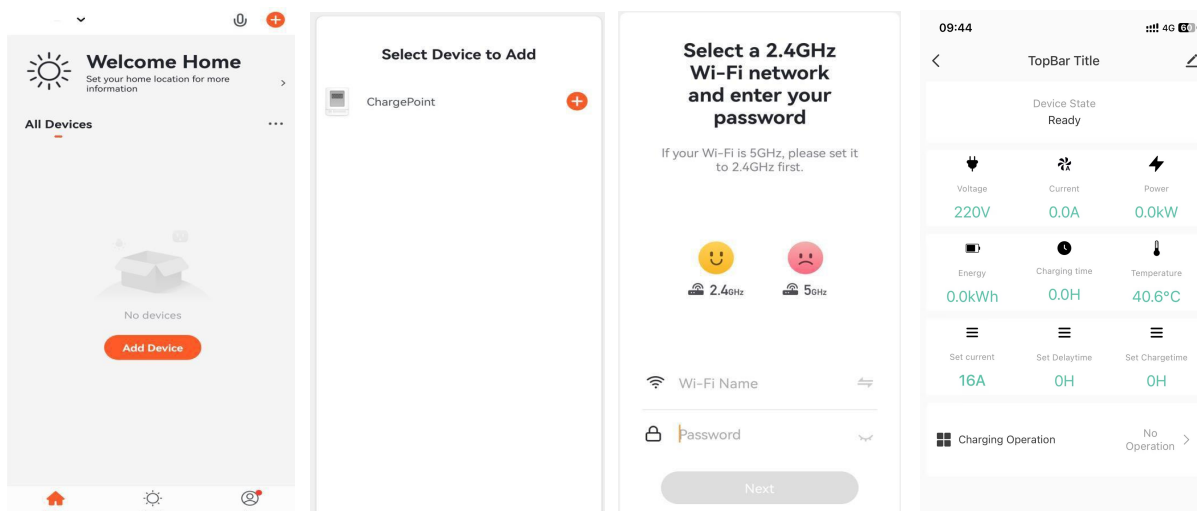

GUARANTEE

Product Name: _____

Product Model: _____

Date of Production: _____

Date of Sale: _____

Manufacture: _____

After-Sales Service Telephone: _____

Remark: _____

Thanks to purchase our company's products. We sincerely hope you would be satisfied with our product and service. In order to improve customer service, please follow the Customer Service Process to get help if you meet problem.

Please read the warranty terms as follows

carefully and provide valuable comments and suggestions.

1, 1 year upon date of purchase.

2, Guarantee service is subject to normally using.

3, All of damage by man-made(tear open the housing, tear off the sticker, unnormal using).
or losing this card, will not guarantee.